

AREA OF LAND :- 0.478 ACRE = 20821 SQ. FT. = 47.8 DECIMAL (AS PER L.R. PORCHAL)

AREA OF LAND :- 0.457 ACRE = 19970 SQ. FT. (AS PER SITE)

AREA OF LAND AFTER GIFTING :- 19599 SQ. FT.

NATURE OF LAND :- KRISTIBHAVAN

OWNER'S LAND SHOWN IN COLOUR
ROAD SHOWN IN COLOUR
DRAIN SHOWN IN COLOUR
EXISTING CONST. SHOWN IN COLOUR
GIFTED LAND SHOWN IN COLOUR

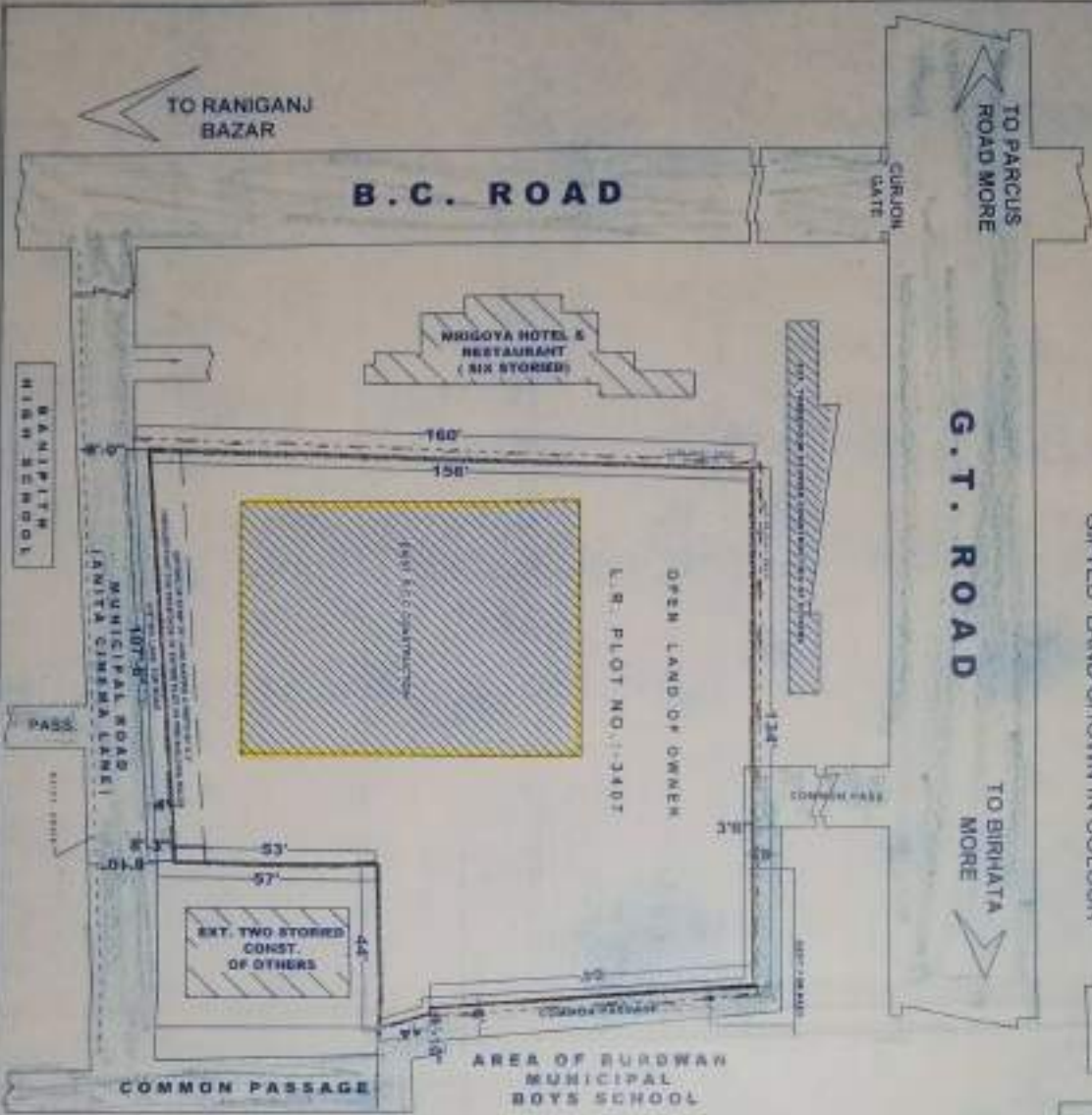

SITE PLAN FOR THE PROPOSED B+G+II STORED (12.5 MTR.) COMMERCIAL CUM RESIDENTIAL BUILDING OF M/S ANITA ENTERPRISE PARTNERSHIP FIRM, MANAGING PARTNER MONORANJAN MONDAL, SID LATE GOURCHAND MONDAL (REGISTERED OFFICE:- 53C/1 DR. S.G. BANERJEE ROAD, P.S. BELLAGHATA, KOLKATA-700010, BRANCH OFFICE:- B.C. ROAD, BURDWAN, P.S. BURDWAN, DIST. PURBA BARDHAMAN) AT MAHALLA:- B.C. ROAD, HOLDING NO.:- 83, WARD NO.:- 34, R.S. PLOT NO.:- 3186/3263, R.S. KH. NO.:- 1458, L.R. PLOT NO.:- 3407, L.R. KHATAN NO.:- 8006, MOUZA :- RADHANAGAR, J.L. NO.:- 39, UNDER BURDWAN MUNICIPALITY, P.S. BURDWAN, DIST. PURBA BARDHAMAN, PIN:-713101.

OFFICE USE :-

Sumitranil Bardhaman
 Chairman
 Burdwan Municipality

[Signature]
 Chairman
 Burdwan Municipality

[Signature]
 Managing Partner

DRAWN BY :-

OWNER :-

Confirmation

OFFICE OF THE BURDWAN	
MUNICIPALITY	
Engineering Deptt.	
Regd. No.	138.
File Mark	VI-4
Date	11/01/2019